



Links Road , Coventry, CV6 3DN Offers over £170,000

Evans Estates is delighted to present this charming two-bedroom semi-detached house, ideally suited for first-time buyers and offered with no upward chain. Nestled in the desirable Radford area of Coventry, this property boasts a welcoming atmosphere and practical features that make it a perfect choice for those looking to settle in a vibrant community.

Upon entering, you are greeted by a spacious entrance hall that leads to two inviting reception rooms. The lounge provides a comfortable space for relaxation, while the kitchen diner offers a delightful area for family meals and entertaining guests. The property benefits from double glazing and gas central heating, ensuring warmth and energy efficiency throughout the year.

On the first floor, you will find two well-proportioned bedrooms, each offering a peaceful retreat for rest and relaxation. The bathroom is conveniently located to serve both bedrooms, making it ideal for families or guests.

Externally, the property features gardens to both the front and rear, providing ample outdoor space for gardening, play, or simply enjoying the fresh air. The location on Links Road offers easy access to local amenities, schools, and transport links, making it a

- No Upward Chain
- Semi Detached House
- Lounge and Kitchen Diner
- Two Bedrooms

Viewing

Please contact our Evans Estates Office on 02476333363 if you wish to arrange a viewing appointment for this property or require further information.



Floor Plan

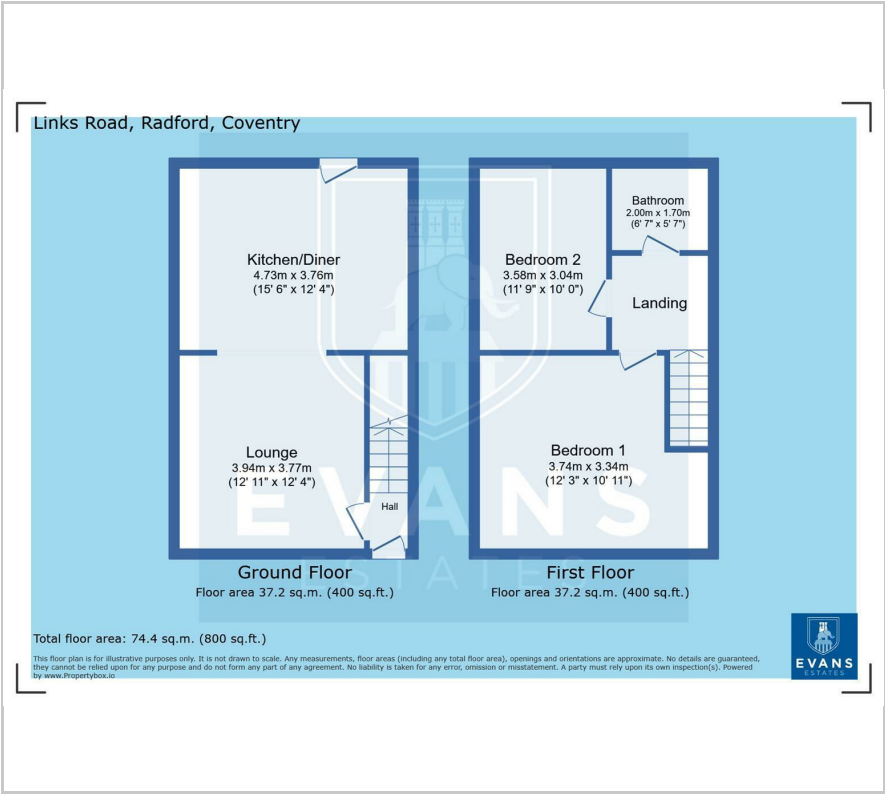

Area Map



Energy Efficiency Graph

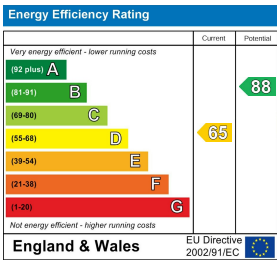

These particulars, whilst believed to be accurate are set out as a general outline only for guidance and do not constitute any part of an offer or contract. Intending purchasers should not rely on them as statements of representation of fact, but must satisfy themselves by inspection or otherwise as to their accuracy. No person in this firms employment has the authority to make or give any representation or warranty in respect of the property.